

**LEGEND:**

- 000.00 EXISTING GROUND SPOT ELEVATIONS (TOPO SURVEY MAY 2012)
- EXISTING MANHOLE
- EXISTING CATCHBASIN
- EXISTING HYDRANT
- EXISTING WATER VALVE
- HP EXISTING HYDRO POLE
- EXISTING FENCE
- EXISTING CURB
- NEW CONC. CURB & GUTTER
- NEW CONC. SIDEWALK
- NEW CATCH BASIN
- NEW TRAFFIC SIGN POLE BASE (SEE DETAIL 1 DWG D1 FOR DETAILS)
- NEW TCM TRAFFIC POLE BASE FOR PERMANENT DRIVE FEEDBACK SIGN (SEE DETAIL 2 DWG D1 FOR DETAILS)

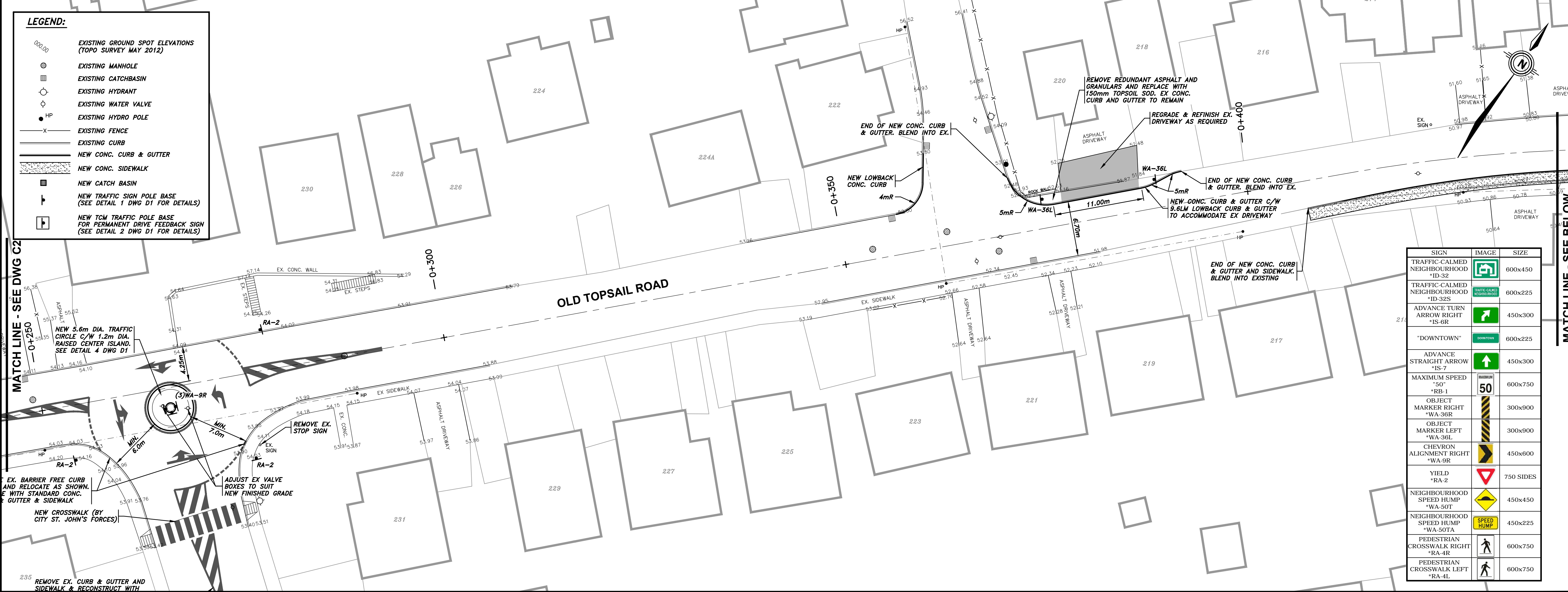

SIGN	IMAGE	SIZE
TRAFFIC CALMED NEIGHBOURHOOD *ID-32		600x450
TRAFFIC CALMED NEIGHBOURHOOD *ID-32S		600x225
ADVANCE TURN ARROW RIGHT *IS-6R		450x300
'DOWNTOWN' ADVANCE STRAIGHT ARROW *IS-7		600x225
MAXIMUM SPEED *50		600x750
OBJECT MARKER RIGHT *WA-36R		300x900
OBJECT MARKER LEFT *WA-36L		300x900
CHEVRON ALIGNMENT RIGHT *WA-9R		450x600
YIELD *RA-2		750 SIDES
NEIGHBOURHOOD SPEED HUMP *WA-50T		450x450
NEIGHBOURHOOD SPEED HUMP *WA-50TA		450x225
PEDESTRIAN CROSSWALK RIGHT *RA-4R		600x750
PEDESTRIAN CROSSWALK LEFT *RA-4L		600x750

- NOTES
1. TOPOGRAPHIC SURVEY BY CITY ST. JOHN'S FORCES.
  2. ALL WORK TO BE PERFORMED IN ACCORDANCE WITH THE CITY OF ST. JOHN'S SPECIFICATIONS BOOK.
  3. ANY DISTURBED AREAS REQUIRED FOR SIGN INSTALLATION OR MINOR CONSTRUCTION WORK TO BE RESTORED TO ORIGINAL CONDITIONS OR BETTER.
  4. CONTRACTOR RESPONSIBLE TO SECURE WORK AREA DURING CONSTRUCTION FOR TRAFFIC AND PUBLIC SAFETY.
  5. CONTRACTOR TO VERIFY ALL DIMENSIONS AND ELEVATIONS ON SITE BEFORE PROCEEDING WITH THIS WORK. (DO NOT SCALE FROM DRAWINGS).
  6. CONTRACTOR TO ENSURE NO SIGNAGE INSTALLATION OR MINOR CONSTRUCTION WORK OCCURS ON PRIVATE PROPERTY.
  7. CONTRACTOR RESPONSIBLE FOR LOCATING ANY EXISTING UNDERGROUND INFRASTRUCTURE (IE ELECTRICAL, TELEPHONE, WATER, SEWER, ETC.) PRIOR TO INSTALLATION NEW SIGN POSTS TO ENSURE NO CONFLICTS.
  8. CONTRACTOR RESPONSIBLE FOR INSTALLING NEW SIGN BASES & POSTS. CITY OF ST. JOHN'S FORCES TO ORDER AND INSTALL SIGNS ONTO POSTS. CONTRACTOR TO COORDINATE WITH CITY OF ST. JOHN'S FORCES.
  9. SIGNS MAY BE INSTALLED ONTO EXISTING HYDRO POLES OR LIGHT STANDARDS WHERE POSSIBLE. COORDINATE WITH CITY OF ST. JOHN'S.
  10. STREET DIMENSIONS ARE MEASURED FROM FACE OF CURB UNLESS NOTED OTHERWISE.
  11. ALL DISTURBED AREAS BEYOND LIMITS OF WORK TO BE RESTORED TO ORIGINAL CONDITION OR BETTER.
  12. ALL SIDEWALKS TO BE INSTALLED IN ACCORDANCE WITH DRAWINGS 10-330-03, 10-330-04, AND 10-330-11 OF THE CITY ST. JOHN'S SPECIFICATIONS BOOK.
  13. BARRIER FREE CURB RAMPS TO BE INSTALLED AT LOCATIONS SHOWN IN ACCORDANCE WITH ACCESSIBILITY ACT AND REGULATIONS.
  14. ALL NEW LINE PAINTING AND INSTALLATION OF SPEED HUMPS TO BE COMPLETED BY CITY ST. JOHN'S FORCES.

NO.	REVISIONS	DATE
3	ADDED RECON BLOCK RETAINING WALL	30/05/12
2	REVISED PEDESTRIAN CROSSWALK LOCATION M'CLEOUGHLAN STREET	29/05/12
1	REVISED TRAFFIC CIRCLE	28/05/12
0	ISSUED FOR REVIEW	17/05/12

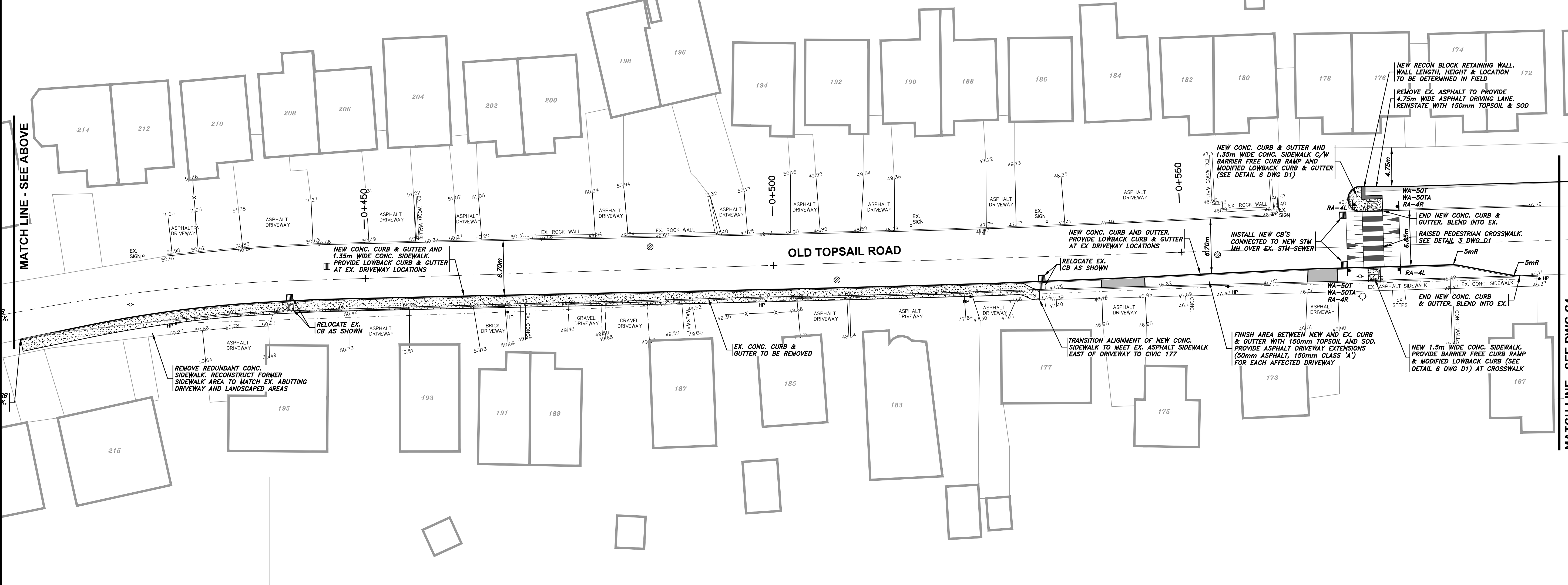

PROFESSIONAL STAMP

PROVINCE OF NEWFOUNDLAND PERMIT HOLDER Class 'A' This Permit Allows PINNACLE ENGINEERING LIMITED To practice Professional Engineering in Newfoundland and Labrador. Permit No. as issued by APEGN L0331 which is valid for the year 2012.

CLIENT  
**ST. JOHN'S**  
DEPARTMENT OF ENGINEERING

PROJECT TITLE  
**OLD TOPSAIL ROAD TRAFFIC CALMING**

SHEET TITLE  
**OLD TOPSAIL ROAD PLAN - 2**

PROJECT NO.  
**12026**

DRAWN BY  
MEWC

CHECKED BY  
KHH

DATE  
MAY 2012

DRAWING NO.  
**C3**

SCALE  
1 : 250